

100 SERIES ASSEMBLY INSTRUCTIONS

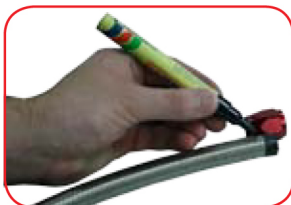

Wrap masking or electrical tape tightly around the hose to prevent fraying and cut with hose cutters for best results.



Mark the hose with a felt pen to detect any movement while the assembly process is completed.

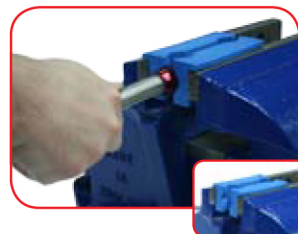

Place the socket in a vice, remove the tape from the hose and push it into the nut while twisting the hose. AeroFlow's soft jaw vice adapters (inset) are recommended to prevent damage to fittings.



Lubricate the threads on the hose and nipple with a aero paste and place the nipple in a vice.



Holding the hose, push the socket nut onto the nipple thread.

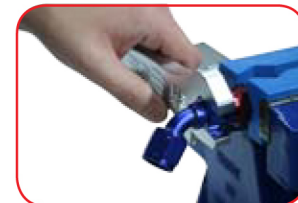

Tighten the fitting until the socket has a gap of approximately 1.5mm. Check that the mark on the hose has not moved from the end of the socket nut.

200 SERIES ASSEMBLY INSTRUCTIONS

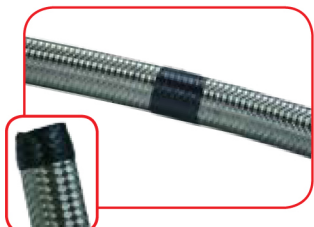

Using hose cutters cut the braided hose to the required length by wrapping masking or electrical tape around it to prevent fraying. Trim the hose of any stray braid to form a clean cut (inset).

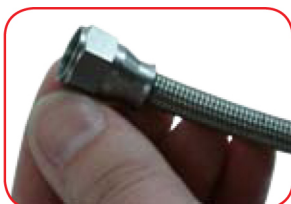

Thread the socket through the hose with the threaded end of the socket towards the cut end and push it back.



Insert the olive between the braid and the Teflon® tube making sure none of the braid is trapped between the Teflon and the olive.



Push the olive into the braid using an olive tool or a hard surface ensuring the olive has been inserted square.



Push the hose back onto the nipple. Using a non-residual lube, lubricate the nipple and start threading the socket onto the nipple threads tightening hard.

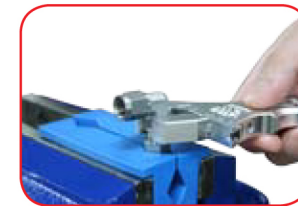

Place the socket in the vice to complete the tightening process. Ensure the gap between the nipple and the socket is no bigger than approximately 1mm.

Note: Teflon is a registered trademark of Du Pont

400 SERIES ASSEMBLY INSTRUCTIONS



Cut the hose square with a hose cutter or sharp knife.



Lubricate both the inside of the hose and the outside of the nipple using a non-residual lube. Clamp the fitting into a vice.



Push the hose end into the barb until it fits snugly under the collar.